

GENERAL DE SELLOS

GENERAL MECHANICAL SEAL LIST



SELLOS CARTUCHO

CARTRIDGE SEALS

TIPO TYPE 771

SELLO DOBLE PARA BOMBAS ANSI SEAL FOR ANSI PUMPS

Presión (pressure):
Vacuum to 370 psig (25 bar)

Temperatura (temperature):
-20°F to 450°F (-29°C up to 232°C)

Velocidad (velocity): 6000 fpm (30 m/s)



TIPO TYPE 771DN

SELLO DOBLE PARA TRABAJO PESADO HEAVY DUTY DOUBLE SEAL

Presión (pressure):
Vacuum to 370 psig (25 bar)

Temperatura (temperature):
-20°F to 450°F (-29°C up to 232°C)

Velocidad (velocity): 6000 fpm (30 m/s)



TIPO TYPE 771M

SELLO PARA BOMBAS DIN SEAL FOR DIN PUMPS

Presión (pressure):
Vacuum to 370 psig (25 bar)

Temperatura (temperature):
-20°F to 450°F (-29°C up to 232°C)

Velocidad (velocity): 6000 fpm (30 m/s)



TIPO TYPE 773

SELLO DOBLE PARA TRABAJO PESADO EN CENTRALES AZUCARERAS / DOUBLE SEAL FOR HEAVY DUTY IN SUGAR MILL

Presión (pressure):
Vacuum to 400 psig (27 bar)

Temperatura (temperature):
-20°F to 450°F (-29°C up to 232°C)

Velocidad (velocity): 5000 fpm (25 m/s)



TIPO TYPE 830

SELLO TIPO CARTUCHO PARA LA INDUSTRIA PETROLERA / CARTRIDGE SEAL FOR PETROCHEMICAL INDUSTRY

Presión (pressure):
Vacuum to 750 psig (52 bar)

Temperatura (temperature):
-20°F to 572°F (-29°C to 300°C)

Velocidad (velocity): 3600 fpm (18 m/s)



TIPO TYPE 530

SELLO ROTATORIO PARA TRABAJO PESADO / HEAVY DUTY ROTARY CARTRIDGE SEAL

Presión (pressure):
Vacuum to 200 psig (14 bar)

Temperatura (temperature):
-20°F to 450°F (-29°C to 232°C)

Velocidad (velocity): 4000 fpm (20 m/s)



TIPO TYPE 535

SELLO TIPO CARTUCHO PARA BOMBAS ANSI ROTARY SINGLE CARTRIDGE SEAL

Presión (pressure):
Vacuum to 200 psig (14 bar)

Temperatura (temperature):
-20°F to 450°F (-29°C to 232°C)

Velocidad (velocity): 4000 fpm (20 m/s)



TIPO TYPE 420

SELLO CONCÉNTRICO DOBLE CONCENTRIC DOUBLE SEAL

Presión (pressure):
Vacuum to 250 psig (17 bar)

Temperatura (temperature):
-20°F up to 450°F (-29°C up to 232°C)

Velocidad (velocity): 5000 fpm (25m/s)



TIPO TYPE 422

SELLO DOBLE PARA MANEJO DE PULPA Y LODO PESADO / DOUBLE CARTRIDGE SEAL FOR HEAVY MUDS

Presión (pressure):
Vacuum to 400 psig (27 bar)

Temperatura (temperature):
-20°F up to 450°F (-29°C up to 232°C)

Velocidad (velocity): 5000 fpm (25 m/s)



TIPO TYPE 424

SELLO EXTERNO PARA ABRASIVOS EXTERNAL SEAL FOR SLURRIES

Presión (pressure):
Vacuum to 200 psig (14 bar)

Temperatura (temperature):
-20°F up to 450°F (-29°C up to 232°C)

Velocidad (velocity): 2950 fpm (15m/s)



TIPO TYPE 480

SELLO DOBLE PARTIDO PARA PROCESOS CON POLVO SECO / DOUBLE SPLIT SEAL FOR DRY PROCESSES

Presión (pressure):
Vacuum to 40 psig (2 bar)
Temperatura (temperature):
-20°F to 104°F (-29°C to 40°C)
Velocidad (velocity): 260 fpm (1.3 m/s)



TIPO TYPE 481

SELLO CARTUCHO SIN RODAMIENTOS PARA MOLINOS / CARTRIDGE SEAL WITHOUT BEARINGS FOR MILLS

Presión (pressure):
Vacuum to 300 psig (20 bar)
Temperatura (temperature):
-22°F to 600°F (-30°C to 315°C)
Velocidad (velocity): 1575 fpm (8 m/s)
481R: Para cargas altas



TIPO TYPE 482R

SELLO DOBLE CON RODAMIENTO PARA MEZCLADORES Y AGITADORES / DOUBLE SEAL WITH BEARING FOR MIXERS AND AGITATORS

Presión (pressure):
Vacuum to 300 psig (20 bar)
Temperatura (temperature):
-22°F to 600°F (-30°C to 315°C)
Velocidad (velocity): 1575 fpm (8 m/s)



TIPO TYPE 330

SELLO SIMPLE ROTATORIO PARA ALIMENTACIÓN DE CALDERAS Y LIQUIDOS LIMPIOS / CARTRIDGE SINGLE SEAL FOR BOILER FEED WATER AND CLEAN FLUIDS

Presión (pressure):
Vacuum to 500 psig (34 bar)
Temperatura (temperature):
-20°F to 450°F (-29°C to 232°C)
Velocidad (velocity): 4000 fpm (20 m/s)
Disponible también con brida redonda



TIPO TYPE 180

SELLO DOBLE CARTUCHO PARA LA INDUSTRIA PETROQUIMICA / DUAL CARTRIDGE SEAL FOR PETROCHEMICAL INDUSTRY

Presión (pressure):
Vacuum to 360 psig (25 bar)
Temperatura (temperature):
-100°F a 800°F (-75°C a 425°C)
Velocidad (velocity): 5000 fpm (25 m/s)

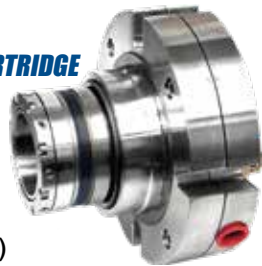

SELLOS PROCESO

PROCESS SEALS

TIPO TYPE 500

SELLO PARA SERVICIO GENERAL / GENERAL SERVICE ROTARY SEAL

Presión (pressure):
Vacuum to 200 psig (14 bar)
Temperatura (temperature):
-20°F to 450°F (-29°C to 232°C)
Velocidad (velocity): 4500 fpm (23 m/s)



TIPO TYPE 500 AL

SELLO PARA SERVICIO GENERAL / GENERAL SERVICE ROTARY SEAL

Presión (pressure):
Vacuum to 200 psig (14 bar)
Temperatura (temperature):
-20°F to 450°F (-29°C to 232°C)
Velocidad (velocity): 4500 fpm (23 m/s)



TIPO TYPE 500B

SELLO BALANCEADO PARA TRABAJO PESADO / HEAVY DUTY BALANCED SEAL

Presión (pressure):
Vacuum to 450 psig (31 bar)
Temperatura (temperature):
-20°F to 450°F (-29°C to 232°C)
Velocidad (velocity): 4000 fpm (20 m/s)



TIPO TYPE 500 ALI

SELLO PARA SERVICIO GENERAL / GENERAL SERVICE ROTARY SEAL

Presión (pressure):
Vacuum to 200 psig (14 bar)
Temperatura (temperature):
-20°F to 450°F (-29°C to 232°C)
Velocidad (velocity): 4500 fpm (23 m/s)



TIPO TYPE 600

SELLO SENCILLO UNIDIRECCIONAL / SINGLE DIRECTIONAL SEAL

Presión (pressure):
Vacuum to 150 psig (10 bar)
Temperatura (temperature):
-20°F to 450°F (-29°C to 232°C)
Velocidad (velocity): 3940 fpm (20 m/s)
Bombas ANSI / Medidas en pulgadas



TIPO TYPE 650

SELLO SENCILLO UNIDIRECCIONAL SINGLE DIRECTIONAL SEAL

Presión (pressure):

Vacuum to 150 psig (10 bar)

Temperatura (temperature):

-20°F to 450°F (-29°C to 232°C)

Velocidad (velocity): 3940 fpm (20 m/s)

Bombas ANSI / Medidas en pulgadas



TIPO TYPE 700

SELLO EXTERNO PARA SERVICIO CORROSIVO / OUTSIDE SEAL FOR CORROSIVE SERVICE

Presión (pressure):

Vacuum to 150 psig (10 bar)

Temperatura (temperature):

-20°F to 450°F (-29°C to 232°C)

Velocidad (velocity): 2950 fpm (15 m/s)



TIPO TYPE 750

SELLO DE PTFE PARA APLICACIONES EXTREMAS / PTFE SEAL FOR HOSTILE APPLICATIONS

Presión (pressure):

Vacuum to 120 psig (8 bar)

Temperatura (temperature):

-75°F to 212°F (-59°C to 100°C)

Velocidad (velocity): 1575 fpm (8 m/s)



TIPO TYPE 300

SELLO ROTATORIO BALANCEADO BALANCED ROTARY SEAL

Presión (pressure):

Vacuum to 450 psig (31 bar)

Temperatura (temperature):

-20°F to 450°F (-29°C to 232°C)

Velocidad (velocity): 4000 fpm (20 m/s)



TIPO TYPE 340

SELLO ROTATORIO PARA ESPACIOS REDUCIDOS / ROTARY SEAL FOR SHORT SPACES

Presión (pressure):

Vacuum to 250 psig (17 bar)

Temperatura (temperature):

-20°F to 450°F (-29°C to 232°C)

Velocidad (velocity): 3600 fpm (18 m/s)



TIPO TYPE 350

SELLO BALANCEADO BALANCED ROTARY SEAL

Presión (pressure):

Vacuum to 450 psig (31 bar)

Temperatura (temperature):

-20°F to 450°F (-29°C to 232°C)

Velocidad (velocity): 4000 fpm (20 m/s)



TIPO TYPE 400

SELLO SIMPLE ROTATORIO SINGLE ROTARY SEAL

Presión (pressure):

Vacuum to 250 psig (17 bar)

Temperatura (temperature):

-20°F to 450°F (-29°C to 232°C)

Velocidad (velocity): 3600 fpm (18 m/s)



SELLOS ESTÁNDAR

STANDARD SEALS

TIPO TYPE 350 DIN

SELLO ROTATORIO BALANCEADO. NORMA 24960 / BALANCED ROTARY SEAL. DIN 24960

Presión (pressure):

Vacuum to 370 psig (25 bar)

Temperatura (temperature):

-20°F to 450°F (-29°C to 232°C)

Velocidad (velocity): 4000 fpm (20 m/s)

Medidas en mm



TIPO TYPE M32/M37

SELLO UNIDIRECCIONAL NO BALANCEADO / UNBALANCED MECHANICAL SEAL

Presión (pressure):

Up to 150 psig (10 bar)

Temperatura (temperature):

-20°F to 450°F (-29°C up to 232°C)

Velocidad (velocity): 3940 fpm (20 m/s)

Bombas DIN / Medidas en mm



TIPO TYPE M3N

SELLO SENCILLO UNIDIRECCIONAL DIN 24960 / SEAL CONICAL SPRING DIN 24960

Presión (pressure):

Vacuum to 150 psig (10 bar)

Temperatura (temperature):

-20°F to 450°F (-29°C to 232°C)

Velocidad (velocity): 3940 fpm (20 m/s)

Bombas DIN / Medidas en mm



TIPO TYPE 800

SELLO TIPO O RING PARA SERVICIO GENERAL / GENERAL SERVICE O RING SEAL

Presión (pressure):
Vacuum to 300 psig (20 bar)

Temperatura (temperature):
-20°F to 450°F (-29°C to 232°C)

Velocidad (velocity):3600 fpm (18 m/s)



TIPO TYPE 858

SELLO NO BALANCEADO PARA SERVICIO GENERAL / UNBALANCED SEAL FOR SERVICE GENERAL

Presión (pressure):
Vacuum to 246.5 psig (17 bar)

Temperatura (temperature):
-20°F to 450°F (-29°C to 232°C)

Velocidad (velocity):3000 fpm (15 m/s)
Medidas en mm



TIPO TYPE 900

SELLO PARA SERVICIO SEVERO SEVERE SERVICE SEAL

Presión (pressure):
Vacuum to 300 psig (20 bar)

Temperatura (temperature):
-74°F to 500°F (-59°C a 260°C)

Velocidad (velocity):3600 fpm (18 m/s)



TIPO TYPE 959

SELLO NO BALANCEADO PARA SERVICIO SEVERO / UNBALANCED SEAL FOR SERVICE SEVERE

Presión (pressure):
Vacuum to 246.5 PSI (17 bar)

Temperatura (temperature):
-74°F to 500°F (-59°C a 260°C)

Velocidad (velocity):3000 fpm (15m/s)
Medidas en mm



TIPO TYPE 800B

SELLO BALANCEADO PARA TRABAJO PESADO / HEAVY DUTY BALANCED SEAL

Presión (pressure):
Vacuum to 750 psig (52bar)

Temperatura (temperature):
20°F a 450°F (-29°C a 232°C)

Velocidad (velocity):3600 fpm (18 m/s)



TIPO TYPE 800T

SELLO TIPO O RING PARA SERVICIO GENERAL /GENERAL SERVICE O RING SEAL

Presión (pressure):
Vacuum to 174 psig (12 bar)

Temperatura (temperature):
20°F a 450°F (-29°C a 232°C)

Velocidad (velocity):3000 fpm (15m/s)
Sección delgada



TIPO TYPE 900B

SELLO BALANCEADO CON CUÑA EN PTFE BALANCED SEAL WITH PTFE WEDGE

Presión (pressure):
Vacuum to 750 psig (52 bar)

Temperatura (temperature):
-74°F a 500°F (-59°C a 260°C)

Velocidad (velocity):3600 fpm (18 m/s)



TIPO TYPE 900T

SELLO PARA SERVICIO SEVERO SEVERE SERVICE SEAL

Presión (pressure):
Vacuum to 180 psig (12 bar)

Temperatura (temperature):
-74°F a 500°F (-59°C a 260°C)

Velocidad (velocity):3000 fpm (15m/s)
Sección delgada



TIPO TYPE 150

SELLO PARA ALTA TEMPERATURA HIGH TEMPERATURE BELLOW SEAL

Presión (pressure):
Vacuum to 360 psig (25 bar)

Temperatura (temperature):
-100°F to 800°F (-75°C to 425°C)

Velocidad (velocity):5000 fpm (25 m/s)



TIPO TYPE 100

SELLO DE FUELLE METÁLICO METAL BELLOW SEAL WITH DRIVE LUGS

Presión (pressure):
Vacuum to 360 psig (25 bar)

Temperatura (temperature):
-40°F to 500°F (-40°C to 260°C)

Velocidad (velocity):5000 fpm (25 m/s)



TIPO TYPE 151

**SELLO PARA ALTA TEMPERATURA
HIGH TEMPERATURE SEAL DRIVE LUGS**

Presión (pressure):
Vacuum to 300 psig (20 bar)
Temperatura (temperature):
-100°F to 800°F (-75°C to 425°C)
Velocidad (velocity): 5000 fpm (25 m/s)
Medidas en pulgadas



TIPO TYPE M7N

**SELLO CON ARANDELA ONDULADA
WAVE SPRING MECHANICAL SEAL**

Presión (pressure):
Vacuum to 250 psig (17 bar)
Temperatura (temperature):
-20°F to 450°F (-29°C to 232°C)
Velocidad (velocity): 5000 fpm (25 m/s)



O.E.M

O.E.M

TIPO TYPE GR-A

**SELLO PARA BOMBAS GRUNDFOS CRK
SEAL FOR GRUNDFOS PUMPS CRK**

Presión (pressure):
Vacuum to 175 psig (12 bar)
Temperatura (temperature):
-30°C a 180°C
Velocidad (velocity): 1960 fpm (10m/s)



TIPO TYPE GR-H

**SELLO PARA BOMBAS GRUNDFOS CR
CARTRIDGE SEAL FOR GRUNDFOS PUMPS CR**

Presión (pressure):
Vacuum to 250 psig (17 bar)
Temperatura (temperature):
-59°C to 260°C
Velocidad (velocity): 5000 fpm (25 m/s)
Sello reparable



TIPO TYPE 700AR

**SELLO MECÁNICO PARA BOMBAS ARMSTRONG
MECHANICAL SEAL FOR ARMSTRONG PUMPS**

Presión (pressure):
Vacuum to 174 psig (12 bar)
Temperatura (temperature):
20°F a 450°F (-29°C a 232°C)
Velocidad (velocity): 4000 fpm (20m/s)



TIPO TYPE TRICLOVER

**SELLO PARA BOMBAS TRICLOVER
SEAL FOR TRICLOVER PUMPS**

Presión (pressure):
Vacuum to 120 psig (8 bar)
Temperatura (temperature):
20°F a 450°F (-29°C a 232°C)
Velocidad (velocity): 2360 fpm (12 m/s)



TIPO TYPE SE-XE

**SELLO PARA BOMBAS FLYGT Y GRINDEX
SEAL FOR FLYGT AND GRINDEX PUMPS**

Presión (pressure):
Vacuum to 180 psig (12 bar)
Temperatura (temperature):
-22°F to 356°F (-30°C to 180°C)
Velocidad (velocity): 1968 fpm (10 m/s)



TIPO TYPE S07

**SELLO PARA BOMBAS ALFA LAVAL
SEALS FOR ALFA LAVAL PUMPS**

CM/FM/MR166A/ME155A
E/GM /MR185/LKH/ALC



SELLOS ESPECIALES

SPECIAL SEALS

TIPO TYPE 580

**SELLO ESPECIAL PARA BOMBAS FLYGT
FLYGT PUMP SEAL**

Presión (pressure):
Vacuum to 145 psig (10 bar)
Temperatura (temperature):
-22°F to 392°F
(-30°C to 200°C)
Velocidad (velocity): 980 fpm (5 m/s)



TIPO TYPE 505

**SELLO PARTIDO PARA BOMBAS Y
AGITADORES / SPLIT SEAL FOR PUMPS
AND MIXERS**

Presión (pressure):
Up to 200 psig (14 bar)
Temperatura (temperature):
Up to 250°F (121°C)
Velocidad (velocity):
1-7/16" to 2-5/8": 3600 Rpm
2-3/4" to 5-1/4": 1800 Rpm



PROTECTORES DE RODAMIENTOS
BEARING PROTECTORS
TIPO TYPE 954 / 950
SELLO LABERINTO / SELLO MAGNÉTICO
Labyrinth Seal / Magnetic Seal
Temperatura (temperature):

Up to 248°F (120°C)

Axial misalignment: 0.015" TIR max

Radial misalignment: 0.015" TIR max

SELLOS MONORESORTE
ELASTOMER BELLOW SEALS
TIPO TYPE 1
SELLO NO BALANCEADO PARA TRABAJO PESADO
Unbalanced Seal for Heavy Duty
Presión (pressure):

Up to 425 psig (29 bar)

Temperatura (temperature):

-40°F to 392°F (-40°C to 200°C)

Velocidad (velocity): 3543 fpm (18 m/s)

TIPO TYPE 2
SELLO NO BALANCEADO PARA TRABAJO PESADO
Unbalanced Seal for Heavy Duty
Presión (pressure):

Up to 425 psig (29 bar)

Temperatura (temperature):

-40°F to 392°F (-40°C to 200°C)

Velocidad (velocity):

3543 fpm (18 m/s)

TIPO TYPE 21
SELLO NO BALANCEADO PARA SERVICIO GENERAL
Unbalanced Seal for General Service
Presión (pressure):

Up to 180 psig (12 bar)

Temperatura (temperature):

Up to 212°F (100°C) for buna

Up to 392°F (200°C) for FKM

Velocidad (velocity):

2950 fpm (15 m/s)

TIPO TYPE 2100
SELLO NO BALANCEADO
Unbalanced Seal
Presión (pressure):

Up to 175 psig (12 bar)

Temperatura (temperature):

-14°F to 392°F (-20°C to 200°C)

Velocidad (velocity):

2952 fpm (15 m/s)

TIPO TYPE 68 / 68M
SELLO AUTOMOTRIZ
Automotive Seal
Presión (pressure):

Up to 90 psig (6 bar)

Temperatura (temperature):

-22°F to 220°F (-30°C to 104°C)

Velocidad (velocity):

2950 fpm (15 m/s)

TIPO TYPE 6 / 6S
SELLO RESORTE CORTO
Compact Single Spring Seal
Presión (pressure):

Vacuum to 145 psig (10 bar)

Temperatura (temperature):

Up to 217°F (103°C)

Velocidad (velocity):

2362 fpm (12 m/s)

TIPO TYPE M
SELLO DE RESORTE CÓNICO
Tapered Spring Seal
Presión (pressure):

Up to 145 psig (10 bar)

Temperatura (temperature):

 -22°F to 220°F
 (-30°C to 104°C)

Velocidad (velocity):

2950 fpm (15 m/s)

TIPO TYPE N
SELLO DE FUELLE COMPACTO
Compact Bellow Seal
Presión (pressure):

Up to 90 psig (6 bar)

Temperatura (temperature):

 -22°F to 392°F
 (-30°C to 200°C)

Velocidad (velocity):

1970 fpm (10 m/s)

TIPO TYPE MG1/MG12/MG13
SELLO SIMPLE ROTATORIO
Single Rotary Seal
Presión (pressure):

Up to 217 psig (15 bar)

Temperatura (temperature):

 -22°F to 392°F
 (-30°C to 200°C)

Velocidad (velocity):

2362 fpm (12 m/s)



ASIENTOS ESTACIONARIOS / STATIONARY SEATS

TABLA DIMENSIONAL DE ESTACIONARIAS (PULG) / STATIONARY SEATS DIMENSIONAL DATA (inch)

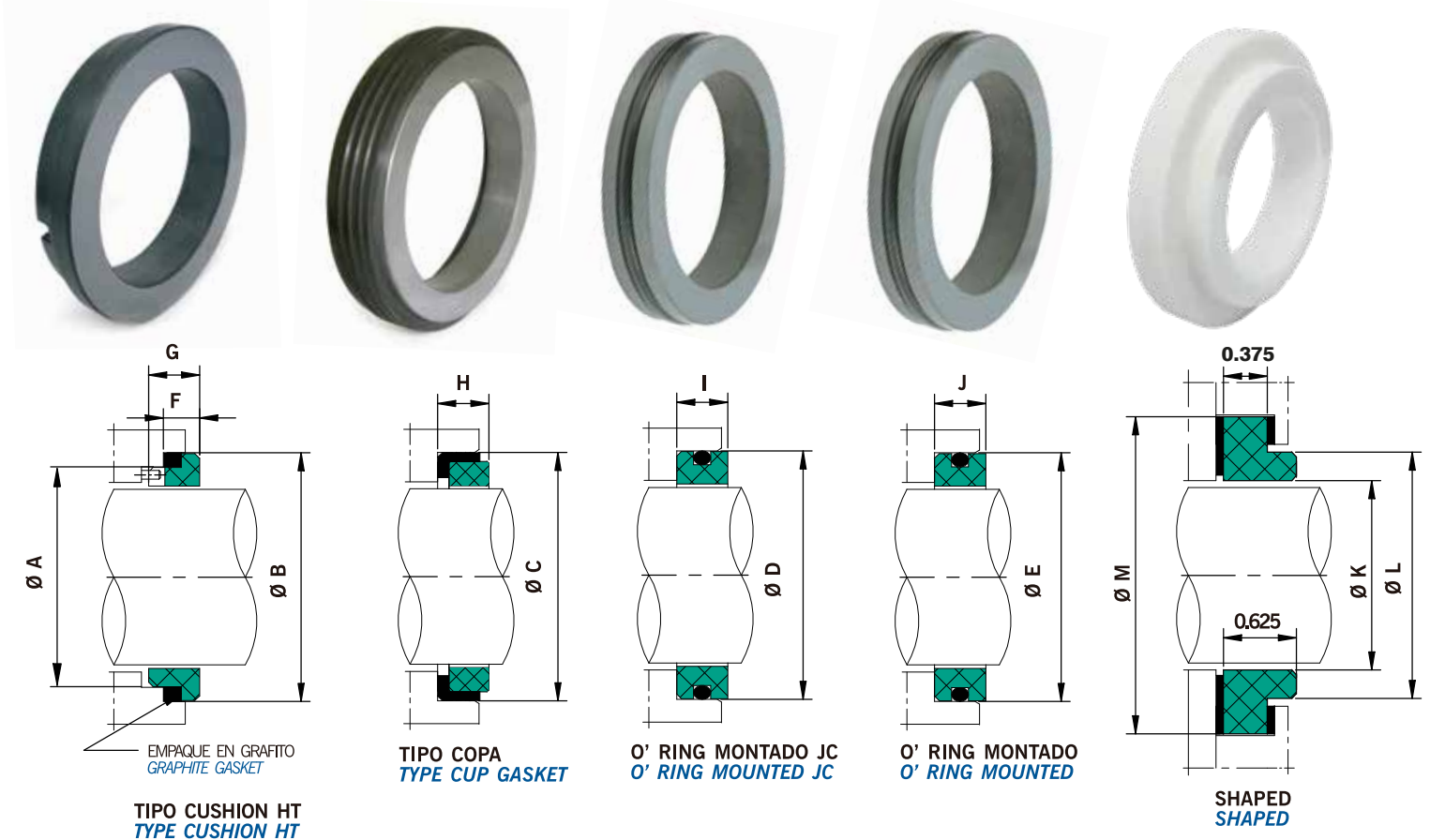

Nota: El diámetro interior de las estacionarias HT, Copa, O´ring mounted y O´ring mounted JC tiene aproximadamente 1/16 más que el eje.
Note: Inside diameter for seat type HT, Cup gasket, O´ring mounted and O´ring mounted JC has approximately 1/16 than shaft size.

SHAFT SIZE	ØA	ØB	ØC	ØD	ØE	F	G	H	I	J
1/2	-	1,000	1,000	1,000	1,000	-	0,313	0,313	0,313	0,313
5/8	-	1,250	1,250	1,250	1,250	-	0,406	0,406	0,375	0,375
3/4	-	1,375	1,375	1,375	1,375	-	0,406	0,406	0,406	0,406
7/8	-	1,500	1,500	1,500	1,500	-	0,406	0,406	0,406	0,406
1	1,384	1,625	1,625	1,625	1,625	0,260	0,437	0,437	0,437	0,437
1 1/8	1,509	1,750	1,750	1,750	1,750	0,260	0,437	0,437	0,437	0,437
1 1/4	1,634	1,875	1,875	1,875	1,875	0,260	0,437	0,437	0,437	0,437
1 3/8	1,759	2,000	2,000	2,000	2,000	0,260	0,437	0,437	0,437	0,437
1 1/2	1,884	2,125	2,125	2,125	2,125	0,260	0,437	0,437	0,437	0,437
1 5/8	2,134	2,375	2,375	2,375	2,375	0,315	0,500	0,500	0,500	0,500
1 3/4	2,259	2,500	2,500	2,500	2,500	0,315	0,500	0,500	0,500	0,500
1 7/8	2,384	2,625	2,625	2,625	2,625	0,315	0,500	0,500	0,500	0,500
2	2,509	2,750	2,750	2,750	2,750	0,315	0,500	0,500	0,500	0,500
2 1/8	2,759	3,000	3,000	3,000	2,875	0,345	0,563	0,563	0,563	0,563
2 1/4	2,884	3,125	3,125	3,125	3,125	0,345	0,563	0,563	0,563	0,563
2 3/8	3,009	3,250	3,250	3,250	3,250	0,345	0,563	0,563	0,563	0,563
2 1/2	3,134	3,375	3,375	3,375	3,375	0,345	0,563	0,563	0,563	0,563
2 5/8	3,134	3,375	3,375	3,375	3,500	0,380	0,625	0,625	0,625	0,625
2 3/4	3,259	3,500	3,500	3,500	3,750	0,380	0,625	0,625	0,625	0,625
2 7/8	3,378	3,750	3,750	3,750	3,875	0,450	0,625	0,625	0,625	0,625
3	3,503	3,875	3,875	3,875	4,000	0,450	0,625	0,625	0,625	0,625
3 1/8	3,628	4,000	-	4,000	4,125	0,450	0,625	-	0,781	0,625
3 1/4	3,753	4,125	-	4,125	4,250	0,450	0,625	-	0,781	0,625
3 3/8	3,878	4,250	-	4,250	4,375	0,450	0,625	-	0,781	0,625
3 1/2	4,003	4,375	-	4,375	4,500	0,450	0,625	-	0,781	0,687
3 5/8	4,128	4,500	-	4,500	4,625	0,500	0,687	-	0,781	0,687
3 3/4	4,253	4,625	-	4,625	4,750	0,500	0,687	-	0,781	0,687
3 7/8	4,378	4,750	-	4,750	4,875	0,500	0,687	-	0,781	0,687
4	4,503	4,875	-	4,875	5,000	0,500	0,687	-	0,781	0,687

SIZE	ØK	ØL	ØM
1	1,120	1,620	2,090
1 1/8	1,250	1,740	2,210
1 3/16	1,310	1,800	2,430
1 1/4	1,370	1,870	2,340
1 3/8	1,500	1,990	2,350
1 1/2	1,620	2,240	2,710
1 5/8	1,750	2,370	2,840
1 3/4	1,870	2,490	3,090
1 7/8	2,000	2,610	3,210
2	2,120	2,740	3,400
2 1/8	2,250	2,860	3,710
2 1/4	2,370	2,990	3,840
2 3/8	2,500	3,050	3,870
2 1/2	2,620	3,240	4,090
2 5/8	2,750	3,360	4,210

ASIENTOS ESTACIONARIOS / STATIONARY SEATS

TABLA DIMENSIONAL DE ESTACIONARIAS (mm) / STATIONARY SEATS DIMENSIONAL DATA (mm)



TIPO G4
TYPE G4



TIPO G6
TYPE G6



TIPO G9
TYPE G9



TIPO G60
TYPE G60

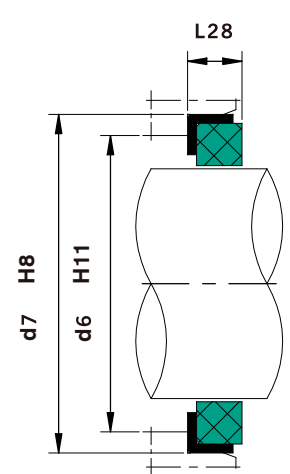
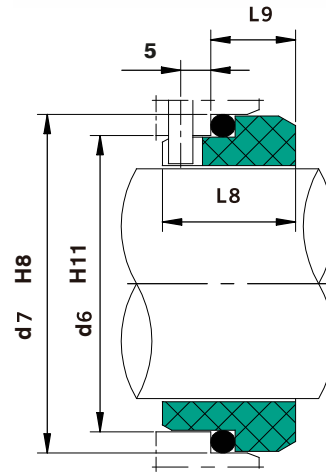
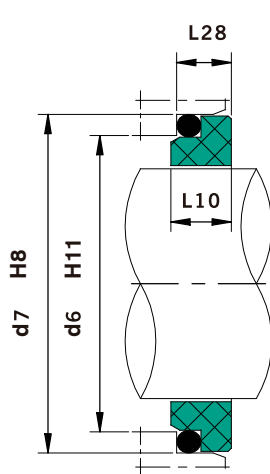
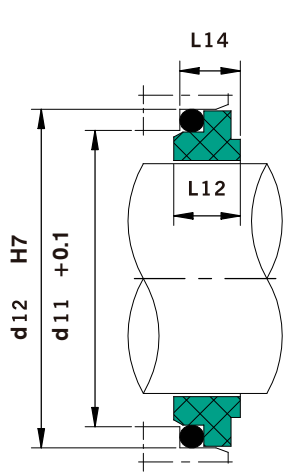

Shaft Size	d6	d7	d11	d12	L8	L9	L10	L12	L14	L28
12	19,0	23,0	17,5	21,6	17,5	10,0	7,5	6,5	5,6	6,6
14	21,0	25,0	20,5	24,6	17,5	10,0	7,5	6,5	5,6	6,6
16	23,0	27,0	22,0	28,0	17,5	10,0	7,5	8,5	7,5	6,6
18	27,0	33,0	24,0	30,0	19,5	11,5	8,5	9,0	8,0	7,5
20	29,0	35,0	29,5	35,0	19,5	11,5	8,5	8,5	7,5	7,5
22	31,0	37,0	29,5	35,0	19,5	11,5	8,5	8,5	7,5	7,5
24	33,0	39,0	32,0	38,0	19,5	11,5	8,5	8,5	7,5	7,5
25	34,0	40,0	32,0	38,0	19,5	11,5	8,5	8,5	7,5	7,5
28	37,0	43,0	36,0	42,0	19,5	11,5	8,5	10,0	9,0	7,5
30	39,0	45,0	39,2	45,0	19,5	11,5	8,5	11,5	10,5	7,5
32	42,0	48,0	42,2	48,0	19,5	11,5	8,5	11,5	10,5	7,5
33	42,0	48,0	44,2	50,0	19,5	11,5	8,5	12,0	10,5	7,5
35	44,0	50,0	46,2	52,0	19,5	11,5	8,5	12,0	11,0	7,5
38	49,0	56,0	49,2	55,0	22,0	14,0	10,0	11,3	10,3	9,0
40	51,0	58,0	52,2	58,0	22,0	14,0	10,0	11,8	10,8	9,0
43	54,0	61,0	53,3	62,0	22,0	14,0	10,0	13,2	12,0	9,0
45	56,0	63,0	55,3	64,0	22,0	14,0	10,0	12,8	11,6	9,0
48	59,0	66,0	59,7	68,4	22,0	14,0	10,0	12,8	11,6	9,0
50	62,0	70,0	60,8	69,3	23,0	15,0	10,5	12,8	11,6	9,5
53	65,0	73,0	63,8	72,3	23,0	15,0	12,0	13,5	12,3	11,0
55	67,0	75,0	66,5	75,4	23,0	15,0	12,0	14,5	13,3	11,0
58	70,0	78,0	69,5	78,4	23,0	15,0	12,0	14,5	13,3	11,0
60	72,0	80,0	71,5	80,4	23,0	15,0	12,0	14,5	13,3	11,0
63	75,0	83,0	74,5	83,4	23,0	15,0	12,0	14,2	13,3	11,0
65	77,0	85,0	76,5	85,4	23,0	15,0	12,0	14,2	13,0	11,0
68	81,0	90,0	82,7	91,5	26,0	18,0	12,5	14,9	13,7	11,3
70	83,0	92,0	83,0	92,0	26,0	18,0	12,5	14,2	13,0	11,3
75	88,0	97,0	90,2	99,0	26,0	18,0	12,5	15,2	14,0	11,3
80	95,0	105,0	95,2	104,0	26,2	18,2	13,0	16,2	15,0	12,0
85	100,0	110,0	100,2	109,0	26,2	18,2	15,0	16,0	14,8	14,0
90	105,0	115,0	105,2	114,0	26,2	18,2	15,0	16,0	14,8	14,0
95	110,0	120,0	111,6	120,3	25,2	17,2	15,0	17,0	15,8	14,0
100	115,0	125,0	114,5	123,3	25,2	17,2	15,0	17,0	15,8	14,0

Nota: la geometría de la cara de la estacionaria puede variar.
 El diámetro interior de las estacionarias tiene entre 1 y 1.5mm más que la medida del eje.
 Note: The stationary face geometry may change
 inside diameter for seats has 1mm up to 1.5mm more than shaft size.

CONTACTO

Clic para enviar correo:
sealco@cisealco.com

Clic para enviar mensaje a
 WhatsApp: 316 473 39 50

PBX: (+57) (604) 424 30 00

Av 37 b # 38 a 12 Itagui-
 Colombia

www.cisealco.com

DISTRIBUIDO POR :